

Vidar Speed – Cameras for Speed Measurement and ANPR

Imaging	Vidar Speed 2xFHD LT	Vidar Speed 5MpHDx LT
Resolution	Sensor 1&2: 3MP (2048x1536)	Sensor 1: 5MP (2432x2048) Sensor 2: 1.5MP (1440x1080)
Max FPS	60 @ 1080p	45 @ 3MP on sensor 1 or 120 @ 720p on sensor 2
Sensor	Sensor 1 & 2: Color, Global Shutter	
Day/Night switch	Automatic brightness control with predefined traffic environments or manual	
Lens	Motorized zoom and focus, remotely adjustable	
Lens mount	Custom mount	
Angle of View	Optics 1&2: Wide: 26.5° x 20° Tele: 8.1° x 6.1°	Optics 1: Wide 25.1° x 21.3° Tele: 7.7° x 6.4° Optics 2: Wide: 55.7° x 43.2° Tele: 3.4° x 2.5°
Optical Zoom	Optics 1&2: 3.3x	Optics 1: 3.3x Optics 2: 18x
Focal length	Optics 1&2: Variable, 15 – 50 mm	Optics 1: Variable, 15 – 50 mm Optics 2: Variable, 4.8 – 84.6 mm



On-Board ANPR+MMR, powered by:
CARMEN®

Distance ANPR Range

Custom sensor configurations (e.g., resolution, color or b/w), optics (zoom or fix, focal length, etc.) and filters (IR-band, IR-Cut, All Pass, and Polarized) are available upon request.		
Optimal ANPR range at ambient light	20 m – 40 m (65 feet – 130 feet)	
Maximal ANPR range at optimal conditions	40 m (131 feet)	50 m (164 feet)
Maximum ANPR range at "0" lux*	35 m (115 feet)	
Vehicle speed range (at optimal conditions)	0 km/h – 320+ km/h / 0 mph – 199+ mph	
Maximum road width covered (at standard license plate size)	8 m (26 feet)	10 m (33 feet)
Maximum number of lanes	2	

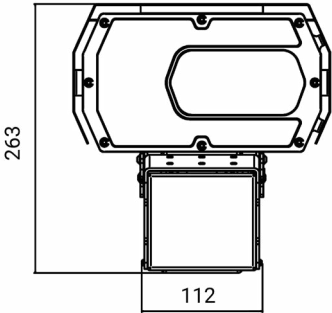

On-Board Intelligence

*In the case of reflective license plates ANPR range can be tailored with different lens and sensor combinations to meet specific project requirements.		
Carmen on-board ANPR	✓	
GDS compliant	✓	
MMR + Color	✓	
Vehicle category	✓	
Video analytics	License plate detection, vehicle direction detection, category	
ADR Recognition	✓	

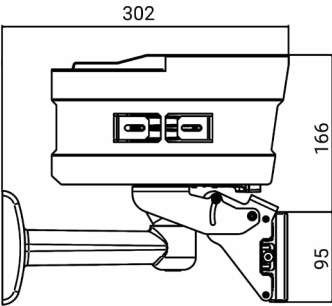

Radar

Additional AI-based features such as seatbelt detection, mobile phone usage detection, driver photo capture and passenger counting can be enabled for selected projects.		
Vehicle speed data	METAS-certified	
Measurement range	0 – 320 km/h (199 mph)	
Measurement accuracy	±1 km/h (0.6 mph) or ±1 % (the bigger of)	
Object tracking	Position, direction, angle, speed	
Measurement frequency	24 GHz*	
Sample rate	75 ms	
Maximum number of lanes covered	4	
Maximum number of objects tracked simultaneously	64	

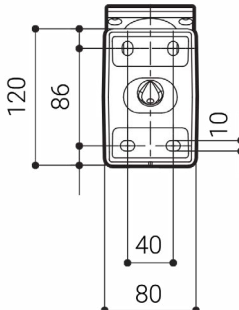

*77 GHz version also available
On request, the device can also be supplied with a radar with different characteristics.

3-year warranty
Made in EU

Technical specifications are subject to change without prior notice.
For any specific requirements beyond our standard products, custom configurations are available.
Please contact our sales team to discuss your project needs and explore tailored solutions. We are happy to help.



www.adaptiverecognition.com

- dual motorized optics · high-performance 4-core ANPR processor · built-in laser trigger · MMR + color · up to 120 FPS
- reads reflective/non-reflective plates simultaneously · overview lens · direction detection · wealth of features
- 850 nm IR illumination · spectacular night-time performance · natively GDS-ready · vehicle categorization

© Copyright Adaptive Recognition Inc.
All rights reserved.

Release date: 16/09/2024

Vidar Speed – Cameras for Speed Measurement and ANPR

Illumination		Vidar Speed 2xFHD LT	Vidar Speed 5MpHDx LT
Wavelength		850 nm	
Illumination modes		Synchronized or continuous	
Illumination beam-angle		22°	
Variable intensity		Adjustable in 100 increments, parity flash (different intensity for odd and even frames)	
Processing & I/O		Any required wavelength (white, 760nm IR, 850nm IR, etc.) even mixed with different beam-angles are also available upon request.	
ANPR Processing unit		ARM 64-bit Quad-Core @ 1.4 GHz	
Communication protocols		ONVIF, ARP, TCP/IP, DHCP, NTP, FTP, HTTP, RTSP, HTTPS, SFTP, DNS, SNMP, SSL/TLS, NTCIP	
I/O ports		12-pin (UART/GPIO/USB/RS232)	
In-built Laser Trigger		8 mRad Point Laser	
Laser wavelength & safety class		905 nm CLASS I (60825-1 2014)	
Certified vehicle speed data		Included	
Storage			
Internal storage size and type		32 GB* SSD	
Stored number of events (Internal)**		approx. 50000	approx. 40000
Event package size for external upload**		350 - 500 kB	400 - 550 kB
External storage type		FTP, SFTP, HTTP, HTTPS	
Electrical Data		* Internal storage: max. 1 TB SSD (available upon request) ** With default settings	
Power requirement		24 - 28 V AC*, min. 2.5A	
Typical power consumption		24 W	26 W
Maximum power consumption		60 W	65 W
Mechanical Data		*36 V DC, when galvanically isolated, double-insulated power supply is in use	
Operating temperature*		-45°C – +70°C (-49°F - +158°F)	
IP&IK rating		IP67, IK10**	
Dimensions (with bracket) L x W x H		302 x 252 x 263 mm / 11.89" x 9.92" x 10.35"	
Weight (with bracket)		5.7 kg / 12.56 lbs	
In the box		Camera, radar, bracket, shield	
Accessories		** For IK10 protection an additional accessory component might be required	
Certificate		MI2 power cable, Ethernet cable, Junction Box, External illuminator	
		Made in EU, NDAA compliant	

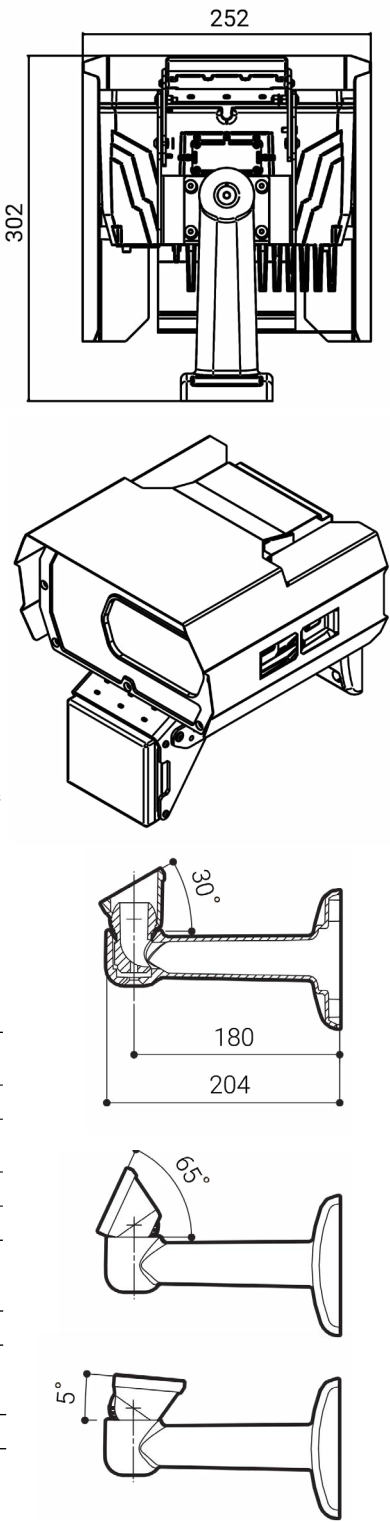

Technical specifications are subject to change without prior notice.
For any specific requirements beyond our standard products, custom configurations are available.
Please contact our sales team to discuss your project needs and explore tailored solutions. We are happy to help.

3-year warranty
Made in EU



www.adaptiverecognition.com

· dual motorized optics · high-performance 4-core ANPR processor · built-in laser trigger · MMR + color · up to 120 FPS
· reads reflective/non-reflective plates simultaneously · overview lens · direction detection · wealth of features
· 850 nm IR illumination · spectacular night-time performance · natively GDS-ready · vehicle categorization

© Copyright Adaptive Recognition Inc.
All rights reserved.

Release date: 16/09/2024